



BUCKAROOS, Inc.

www.buckaroos.com

PRODUCT DATA SHEET



CoolDry™ Insulated Saddles

Insulation meets the stringent 25/50 Flame-Smoke Ratings of ASTM E-84



**CoolDry Insulated Saddle Saves Energy!
Saves Labor! Saves Money!**

Description

The Buckaroos' CoolDry Insulated Saddle is the premier 25-50 Flame/Smoke rated, insulated saddle system in the industry today for commercial piping systems to 250°F. The CoolDry Insulated Saddle consist of a rigid 3.75 PCF Phenolic Foam Pipe Insulation designed for piping to 10" Iron Pipe Size, and 5 PCF Phenolic Foam Pipe Insulation for piping from 11" to 30" Iron Pipe Size.

This insulated pipe support system also features a premium glossy white, puncture resistant vapor barrier membrane with a true perm rating of Zero. The CoolDry Insulated Saddle has no known nutrients that promote mold or fungus problems. A premium self-seal acrylic adhesive tape completes the closure of the system for a secure seal. CoolDry Saddles also features a flared edge and a partial bottom Rib Saddle for a fast and easy install at the clevis hanger. The partial bottom Rib Saddle feature is available in the popular pipe insulation outer diameter sizes.

Guide Specification

Download CoolDry our engineer efficient Insulated Saddles, guide specifications located on our www.cooldrysaddles.com website.

Features and Benefits

- Insulation and facing each meet 25-50 Flame/Smoke ratings per ASTM E-84 on a component basis, which makes the product ideal for piping running through air plenums, or projects demanding the 25-50 Flame/Smoke rating throughout the building.
- A rigid 3.75 PCF or 5 PCF Phenolic Foam Insulation that can be used on virtually all piping systems operating to 250°F, for piping to 30" Iron Pipe Size.
- Excellent compressive strength and damage resistance.
- Pipe Insulation and premium glossy white Zero perm vapor barrier jacketing do not contribute to mold, mildew, bacteria or fungus problems.
- Extremely low "K" factor of .17 at 75°F mean temperature for 3.75 PCF and .20 for 5.0 PCF.
- Excellent resistance to moisture penetration due to its high closed cell structure.
- 100% CFC and HCFC free makes the insulation safe for the environment.
- ASTM E-96, procedure A rated Zero-Perm, puncture resistant glossy white vapor barrier for superior condensation control.
- Extended insulation length past the saddle base allows for a secure tape closure for the adjoining pipe insulation on each side of the CoolDry Insulated Saddle.
- Each Saddle features a partial bottom rib center rib for a perfect fit inside the clevis hanger and a unique flared edge to prevent damage to the vapor barrier facing and insulation.
- Each unit has a genuine "Quick-Inspect" CoolDry sticker applied at the bottom of each saddle for easy jobsite engineer or inspector identification after application.
- Unique "Safe-Pack" packaging protects the insulated support during shipment to the jobsite.

Applications

This saddle is ideal for indoor use on all plumbing, heating, chilled water and refrigeration piping from a - 290°F to +250°F. Because of the insulation's excellent thermal performance and Zero Perm rated vapor barrier jacket, it is the perfect choice for chilled water and other cold piping systems at hanger locations, where most failures are known to occur. The CoolDry Insulated Saddle is ideal for use in schools, hospitals, offices, hotels, food plants, breweries, and pharmaceutical plants.

800-969-3113

www.cooldrysaddles.com

Fax 317-899-0775

CoolDry™ Insulated Saddles

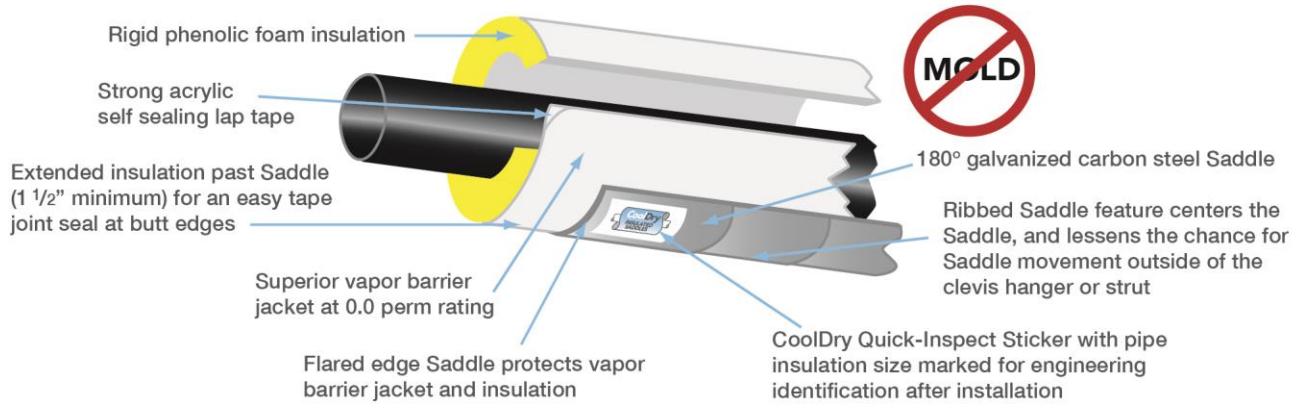

Technical Data – 25/50 Flame-Smoke Rated Phenolic Foam Pipe Insulation

Physical Property	3.75 PCF	5 PCF	Specification Compliance
Recommended Pipe Sizing	To 10" IPS	11" – 30" IPS	Manufacturer Design Limits
Thermal Conductivity @75°F	.17 Btu·in/hr·ft²·°F	.20 Btu·in/hr·ft²·°F	ASTM C-518
Temperature Limits	-290°F to +250°F		
Compressive Strength			
Parallel to rise, min	50 lb/in²	90 lb/in²	ASTM D-1621
Perpendicular to rise, min	40 lb/in²	70 lb/in²	ASTM D-1621
Water Absorption			
% by volume	≤ 2,5	≤ 2,5	ASTM D-209
Water Vapor Permeability	≤ 4 perm-inch	≤ 4 perm-inch	ASTM E-96
Specific Heat	.45 Btu/lb.°F		
Closed Cell Content	min. 95%	min. 95%	ASTM D-2856
Flame spread / Smoke developed			
Up to 4 inches	≤ 25/50	≤ 25/50	ASTM E-84
Saddle, Galvanized Carbon Steel	Hot Dipped G-90		ASTM A-653 (Replaces A527)
Thickness, range	22 gauge - 12 gauge		ASTM A-653 (Replaces A527)

Perfect Vapor Barrier Membrane

The vapor barrier membrane is impermeable to water vapor in accordance with ASTM E-96. It can be wiped clean with a damp cloth, and naturally resists mold formation and accidental puncture. The vapor barrier meets ASTM E-84 25/50 flame and smoke requirements.

Self Seal Lap Premium Acrylic Tape

The premium SSL tape used is an aggressive, high performance acrylic pressure sensitive adhesive that assures a vapor-tight seal when applied at temperatures as low as 10° F. This adhesive has been industry-proven for over twenty years of service.

Product Dimensions

Nominal Pipe Size	Insulation Density	Insulation Length	Saddle Length	Saddle Gauge
1/2" – 3 1/2"	3.75 PCF	9"	6"	20 Ga.
4" – 10"	3.75 PCF	12"	9"	18 Ga.
11" – 18"	5.0 PCF	18"	12"	16 Ga.
20" – 30"	5.0 PCF	24"	18"	14 Ga.